

See C49-65

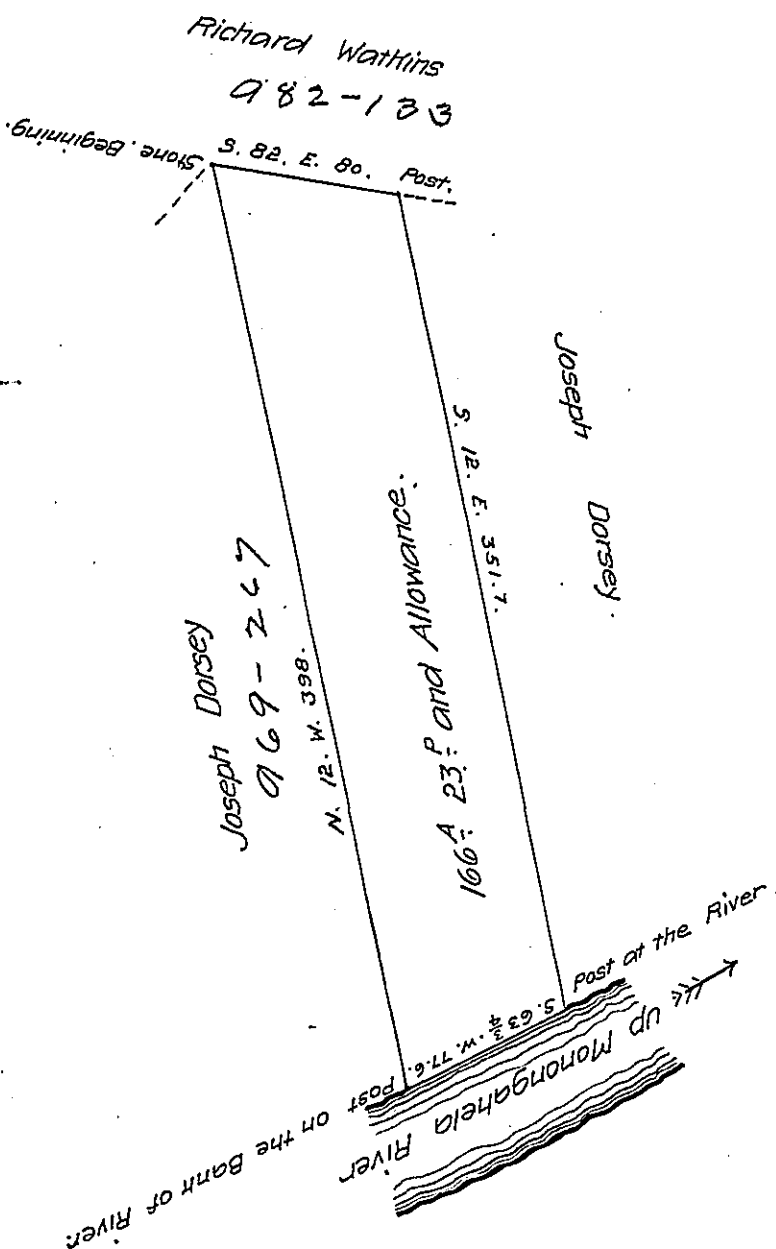

The above is a Draught of a Survey made April 24<sup>th</sup> 1830 in pursuance of a Warrant granted to James Dorsey for 163 Acres of land dated April 8<sup>th</sup> 1830 Containing one hundred and Sixty six Acres and 23 perches and Allowance of six per Cent for highways situate in East Bethlehem Township W County on the West side of the Monongahela River. Note from the appearance of the buildings and Orchard, at the time of Survey, the above land must have been improved at least as early as the land of Joseph Dorsey it being part of the same improvement. there must be some Error in the Date of the improvement. (1822)

Stephen Woods U.S.

To Gabriel Hiester Esq.

Surveyor General.

IN TESTIMONY that the above is a copy of the original remaining on file in the Department of Internal Affairs of Pennsylvania, made conformably to an Act of Assembly approved the 16th day of February, 1833, I have hereunto set my Hand and caused the Seal of said Department to be affixed at Harrisburg, this twenty ninth day of February 1908.

*Henry Howard*  
Secretary of Internal Affairs.